

HWR40/68/96A

WORKTOP REFRIGERATORS

TEMPGUARD® Self-Contained Worktop Refrigerators with EverCheck® Controls

Item # _____

Project: _____

Qty: _____

*AutoCad available on KCL

HWR40/68/96A

5/08

Item # 13168

HWR40A DIMENSIONS

W x D x H

40.25 x 32.3 x 39.9*

*with 6" casters

HWR68A DIMENSIONS

W x D x H

68 x 32.3 x 39.9*

*with 6" casters

HWR96A DIMENSIONS

W x D x H

95.8 x 32.3 x 39.9*

*with 6" casters



HWR40A

Shown



HWR68A

Shown



HWR96A

Shown

- Stainless steel interior and exterior top, front, sides and bottom with galvanized steel back for long life, durability and easy maintenance. The stainless steel top includes a 4" backsplash
- (2) heavy duty epoxy shelves per section are standard, mounted on stainless steel pilasters, shelves are adjustable in 1" increments
- Cabinet door perimeter heater provides condensation control in high humidity environments and is equipped with a back-up heater should the primary heater fail
- Cabinet and doors are insulated with 2³/₈" CFC free, foamed-in-place polyurethane
- 6" heavy duty casters (2 with brakes) are standard
- Doors are constructed of high-grade 300 series stainless steel inside and out
- Doors are self-closing with a stay open feature at 105°
- Stepped door design protects door gasket when product is removed from the cabinet; Snap in magnetic door gaskets are durable and easily removed
- Door hinging is reversible at the factory
- High-efficiency refrigeration system is designed with a large capacity condenser and evaporator resulting in lower overall power consumption; Evaporator coil is coated for extended life
- TempGuard's® EverCheck® controls monitor high and low temperatures, high pressure, clean filter and cabinet temperature functions and provide visual alarms to alert operator to possible problems
- Cartridge-style refrigeration system is easily removable from the main unit for ease of service
- Refrigeration system is equipped with solid state digital controls (Fahrenheit or Celsius display)
- Refrigeration system is designed to maintain proper temperatures with "zero" clearance on ends and at rear
- Defrost cycles are time initiated - temperature terminated
- Removable, cleanable air filter protects condenser and reduces cleaning requirements
- Hot gas condensate evaporator is standard
- Units equipped with 8' - 6" cord and plug
- Refrigerant: R-134A with capillary tube controls

* The HWR40A, HWR68A and HWR96A worktop refrigerators are ENERGY STAR certified.



Warranty

Valid in United States, Canada, Puerto Rico, & U.S. Territories. Contact factory for warranty in other countries.

Two Year - Parts & Labor on entire machine.

Five Year - Parts on: Compressor.



Hoshizaki

HWR40/68/96A WORKTOP REFRIGERATORS

DIMENSIONS

W x D x H
HWR40A 40.25 x 32.3 x 39.9"
HWR68A 68 x 32.3 x 39.9"
HWR96A 95.8 x 32.3 x 39.9" <small>*with 6" casters</small>

WORKTOP REFRIGERATORS

- 1 section worktop refrigerator
- 2 section worktop refrigerator
- 3 section worktop refrigerator

DIMENSIONS/CAPACITY

Model #	HWR40A	HWR68A	HWR96A
Interior Storage Capacity (CF)	8.5 ft ³	18.8 ft ³	29.1 ft ³
Overall Width	40.25"	68"	95.8"
Overall Depth	32.3"	32.3"	32.3"
Height (including 6" casters)	39.9"	39.9"	39.9"
Depth with Door open at 90°	56.8"	56.8"	56.8"
Door Opening Width	22.5"	22.5"	22.5"
Door Opening Height	24.3"	24.3"	24.3"
Adjustable Shelves	2	4	6
Shelf Dimensions (W x D)	22.4" x 24.6"	25" x 24.6"	25.9" x 24.6"
Crated Shipping Weight	317 lb	443 lb	561 lb
Crated Height	40.5"	40.5"	40.5"
Crated Width	44.25"	72"	99.8"
Crated Depth	35.5"	35.5"	35.5"

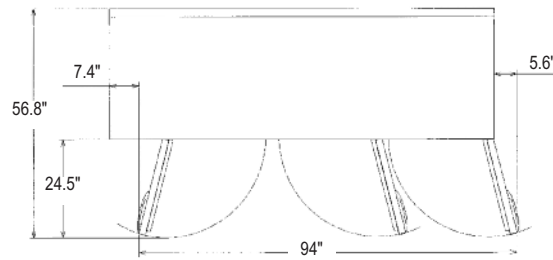
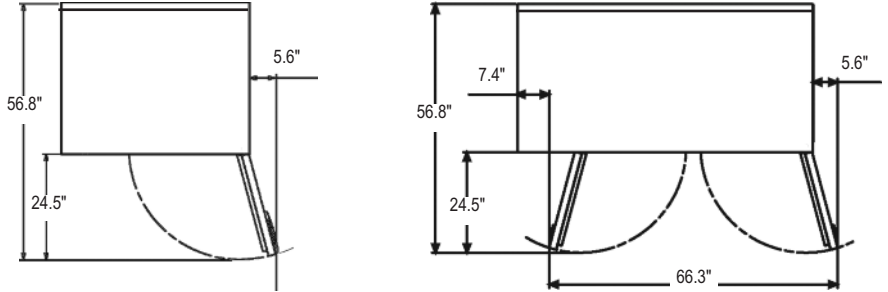

DOOR SWING

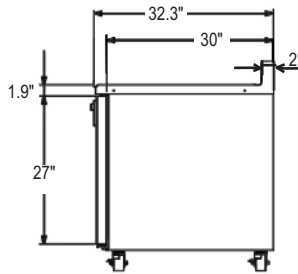

SIDE VIEW (ALL UNITS)

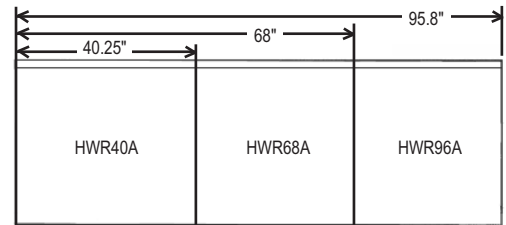

PLAN VIEW (ALL UNITS)

ELECTRICAL & REFRIGERATION DATA

Model #	HWR40A	HWR68A	HWR96A
Voltage	115/60/1	115/60/1	115/60/1
Amperage	5.0	5.0	6.0
HACR Breaker	15.0	15.0	15.0
Electrical Connection (NEMA)	5 - 15P	5 - 15P	5 - 15P
*Energy Consumption (kwh/day)	3.2	4.5	5.2
*Heat Rejection (BTU/Hr.)	449	638	740
Approximate Nominal Compressor BTU/Hr.(HP)	1442 (1/5HP)	1442 (1/5HP)	2010 (1/4HP)
Voltage Range	104 - 126	104 - 126	104 - 126
Ambient Temp. Range	45° - 100°F	45° - 100°F	45° - 100°F
Control Setpoint Range	21° to 53°F	21° to 53°F	21° to 53°F
*Refrigerant	R-134A	R-134A	R-134A

* Based on 100°F ambient cycling at setpoint

OPTIONS

- 6" Legs
- Additional epoxy shelves
- Drawers (two high, two 6" deep 12" x 20" pans/drawer)
- Stainless steel back
- Bull nose top (front & rear)
- Tray pan rack slides (accommodates 18" x 26" pans)
- Reversible hinging (factory modification)



HWR40A

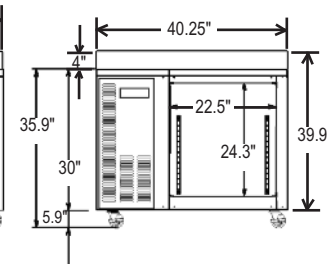

HWR68A

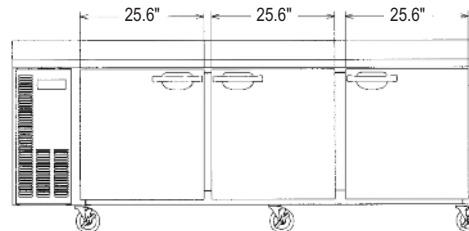
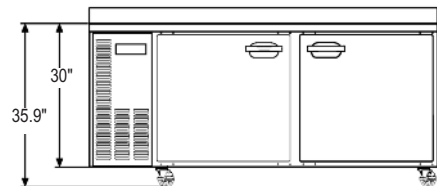

HWR96A



© HOSHIZAKI AMERICA, INC.

618 Hwy. 74 S., Peachtree City, GA 30269

TEL 1-800-438-6087

FAX 1-800-345-1325

www.hoshizaki.com

Printed in U.S.A.

